

MARTIN SSBSC-IR

Same Side Butt Splicer Compact In-Register

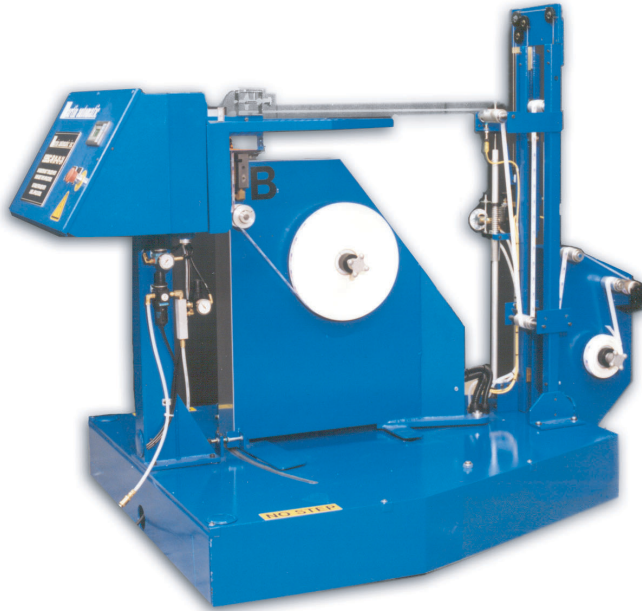

The Martin model SSBSC-IR Butt Splicer makes an in-register zero speed butt splice with single side tape always applied to the same side of the web.

The SSBSC-IR is suitable for the non-stop feeding of PSA coated labels to label applicator machines. By splicing in-register and between labels, the SSBSC-IR provides an uninterrupted stream of labels without waste.



This compact in-register butt splicer for label applicators provides an uninterrupted flow of die-cut labels.

FEATURES:

- The SSBSC-IR is a compact design ideally suited for use with label application equipment.
- The SSBSC-IR always positions the splicing tape on the backside of the label liner where it does not interfere with the continuous feeding of labels.
- The SSBSC-IR splices in-register. This allows the splice to be positioned between labels ensuring that all labels are useable.
- Automatic splicing based on operator settable diameter. Splicing can be also initiated manually.

TYPICAL SPECIFICATIONS:

The SSBSC-IR can be configured to feed labels up to 6 inches (150mm) wide at speeds to meet the requirements of label application equipment.

• Splicing Speed	20 FPM	6 MPM
• Web Width	1 IN	25 MM
• Roll Diameter	24 IN	600 MM
• Tension	1 - 4 lbs.	2.2 - 8.8 KG
• Core Inside Diameter	3 or 6 IN	76 or 152 MM



Martin Engineers Solutions !

Martin MODEL **SSBSC-IR**
 Same Side Butt Splicer Compact In-Register

Elevation View

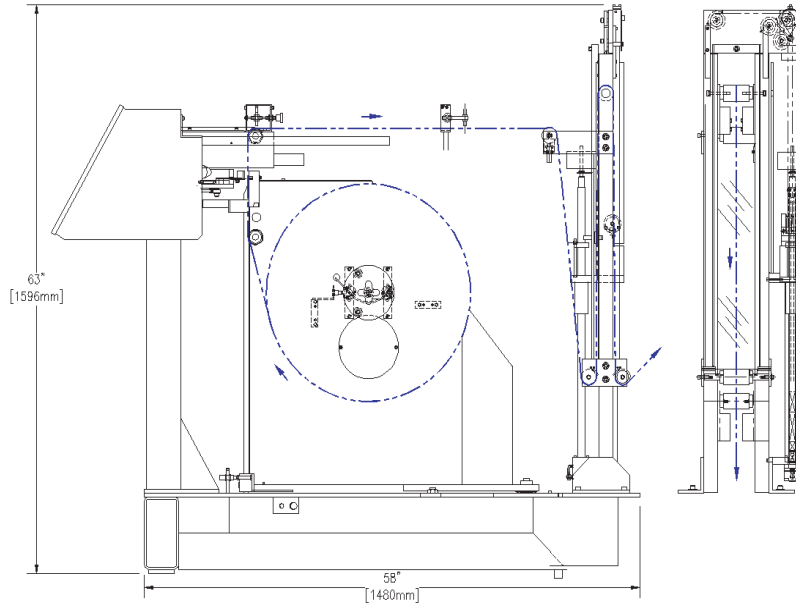

Plan View

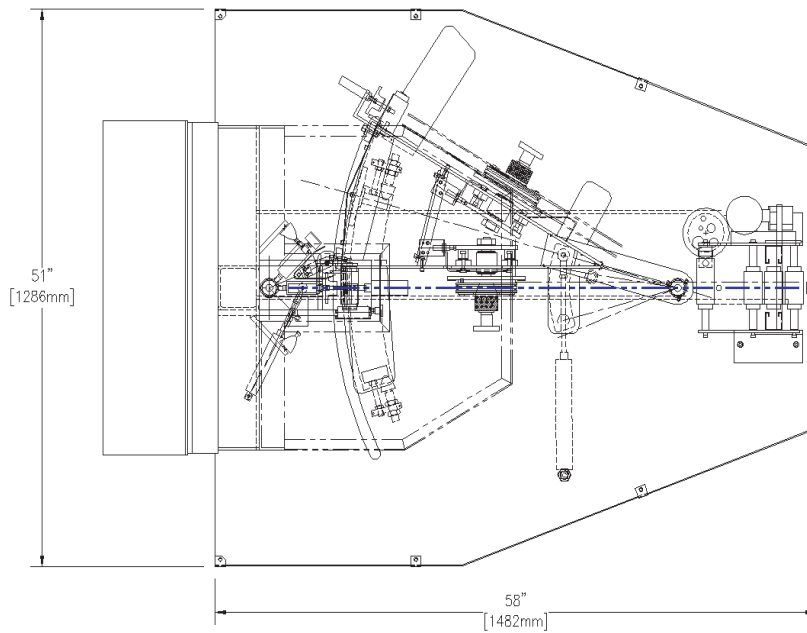

Dimensions vary per application and are for planning purposes.

UTILITY REQUIREMENTS

Pneumatic: 80 PSI (5.5 ATM) 1500 FPM 1 scfm normal operation with a peak of 3 scfm at time of splice.

Electrical: 110V/1PH/60Hz. or 220V/1PH/50Hz.



Martin Automatic, Inc.
 1661 Northrock Court
 Rockford, Illinois 61103, U.S.A.
 Tel: (815) 654-4800 Fax: (815) 654-4810
 www.martinauto.com